

正式图 参考图 CUSTOMER DRAWING  
The requirements of environmental protection  
ROHS2 Halogen free

Mark	ECN NO.	DESCRIPTION	DESIGN	Date:
—	—	NEW VERSION	David Zhou	2014.05.17

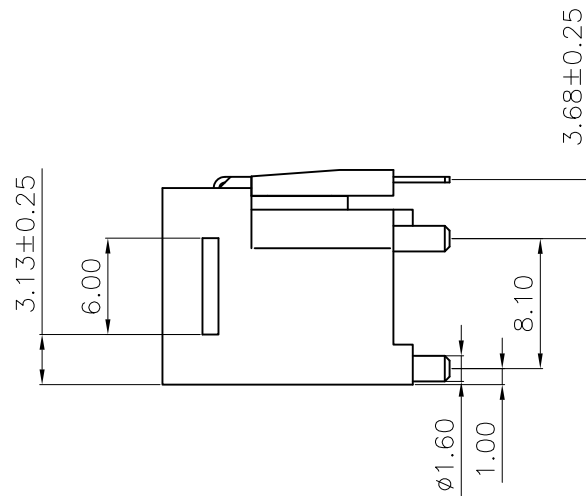
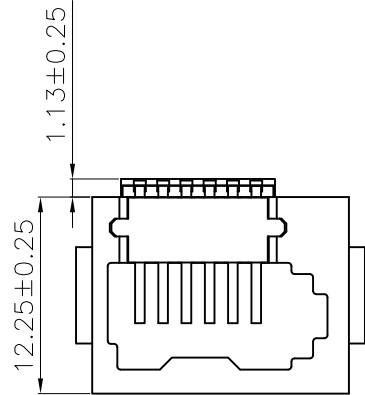

SPECIFICATION:

Electrical:  
Current Rating:1.5Amp max  
Voltage Rating:150VAC max  
Insulation Resistance:500 megohms min  
Contact Resistance:50 milliohms max  
Withstanding Voltage:1000 VAC  
Mechanical:  
Durability:750 Cycles  
Operating Temperature:-40°C~+70°C  
Storage Temperature:-50°C~+75°C  
Contact Normal Force:100g Minimum  
Soldering Temperature:  
260+/-5°C,5sec/95%Areabe covered  
Withstand Temperature: 270+/-5°C,5sec  
No stick tin melting phenomenon

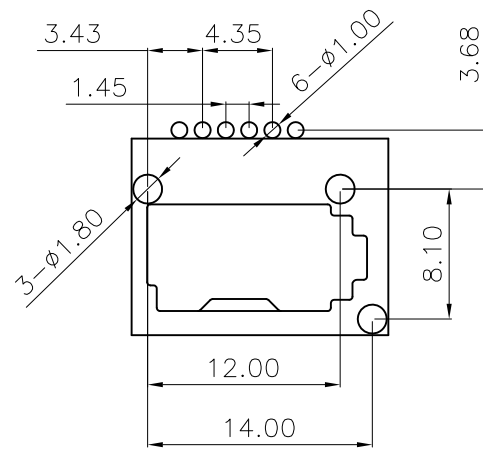
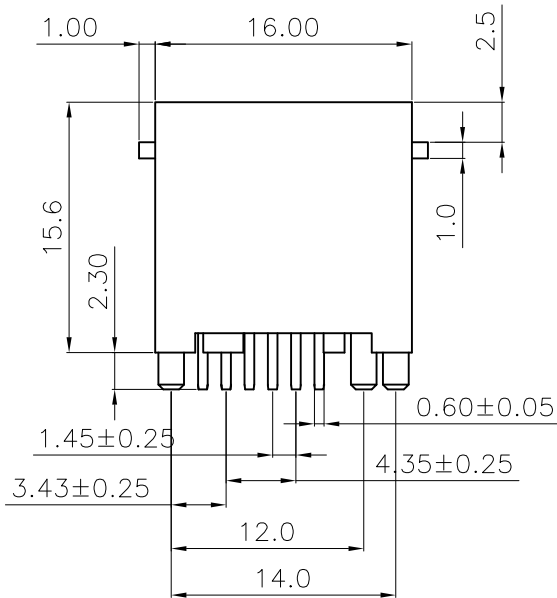

RECOMMENDED PCB LAYOUT  
TOP VIEW  
TOLERANCE:±0.05mm  
PCB THICKNESS: 1.60±0.05mm

P/N: RJ1064W-XXXX-XXXX00X  
Model P/N

Plasting Material:  
 B0:PBT4815 15%GF,UL94-V0 ROHS  
 B4:PBT5615 15%GF,UL94-V0 ROHS&H.F  
 D6:PA66 30%GF,UL94-V0 ROHS&H.F  
 C0:LCP,UL94-V0 ROHS&H.F

Button Color:  
 01:Black  
 02:Red(485C)  
 03:White  
 04:Yellow(114C)  
 08:Gray(Cool Gray2C)

Packing:  
 B:Tray;  R:Tape reel;  
 Chocolate:  
 LED Color Options Table  
 00: NO LED  
 Plating Code:  
 00:Gold Flash  
 01:6u"  
 02:15u"  
 03:30u"  
 04:50u"  
 Contacts:  
 6C:6Pin Contacts  
 4C:4Pin Contacts

NO.	DESCRIPTION	QTY	PARTS MATERIAL	PLATING OR COLOR	REMARK
2	Terminal	6	0.35mm Thickness Copper Alloy,Plated With Gold And Tin In Solder Area.	Plating: Cu40u"+Ni 50u" Min. Selective Gold Plating.(Gold See Part No)	-
1	Housing	1	Choose from P/N	Choose from P/N item color	-

Tolerance X.X ±0.30 X.XX ±0.20 X.XXX ±0.10 Angle ±3.0°	MODEL NAME: BT 601A, Flange, Unshielded, Receptacle,Vertical, Single Port, Tht MODEL No:RJ1064W-XXXX-XXXX00X	DRAWING: David Zhou CHECKED: David Zhou APPROVED:Jacky Lee DATE: 2014.05.17
UNIT:mm	SCALE:1:1 REVISION A0 SHEET 1/1	FILE: CD/LINGYANG DWG NO.RJ1064W-A001

